

# *Super Chief*

Thoroughbred Bumper Pull



*Cherokee*  REG. T.M. *est. 1989*

---

[www.cherokeetrailers.net](http://www.cherokeetrailers.net)

(800) 654-4967

# Super Chief Thoroughbred

## 2 Horse Bumper Pull

15'1" X 6'8" X 7'6"

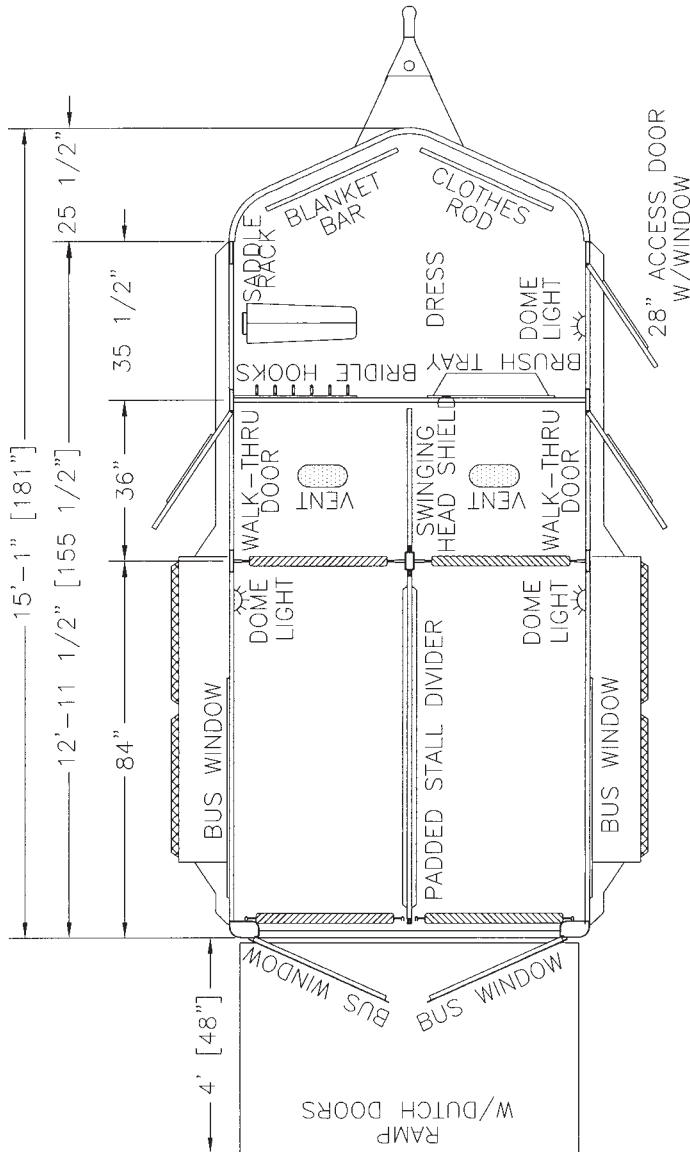

### Axles & Tires:

- \* 2 – 3500 # Torsion Axles
- \* 5 – 235/75r/15 – C
- \* Spare Included

### Dressing Room:

- \* 1 Dome Light
- \* 1 Clothes Bar
- \* 6 Bridle Hook Bar
- \* Camper Door W/Screen On Curb Side
- \* Carpet On Floor
- \* 2 Position Saddle Rack
- \* 2 Brush Trays

### Stall Area:

- \* 2 Padded Butt Bars
- \* Half – Ramp With Double Storm Doors
- \* Side Walls & Roof Lined W/ .050 White Aluminum And Insulated
- \* 48" Rubber On Side Walls And Rear Doors
- \* Heavy Duty Rubber Floor Mats
- \* 2 Dual Framed Full Height Escape Doors W/ Chest Safety Bars
- \* 2 – 19" X 53" Stall Side Windows

### Exterior Finish:

- \* White Skin
- \* Standard Graphics



See your local dealer for options available or visit

[www.cherokeetrailers.net](http://www.cherokeetrailers.net)

**Warranty: 2 Year Hitch to Bumper • 8 Year Structure**

Make and/or Model subject to change without notice