

# Tomahawk

3 Horse



**Cherokee**  REG. T.M. *est. 1989*

---

[www.cherokeetrailers.net](http://www.cherokeetrailers.net)

(800) 654-4967

# Tomahawk 3HSG

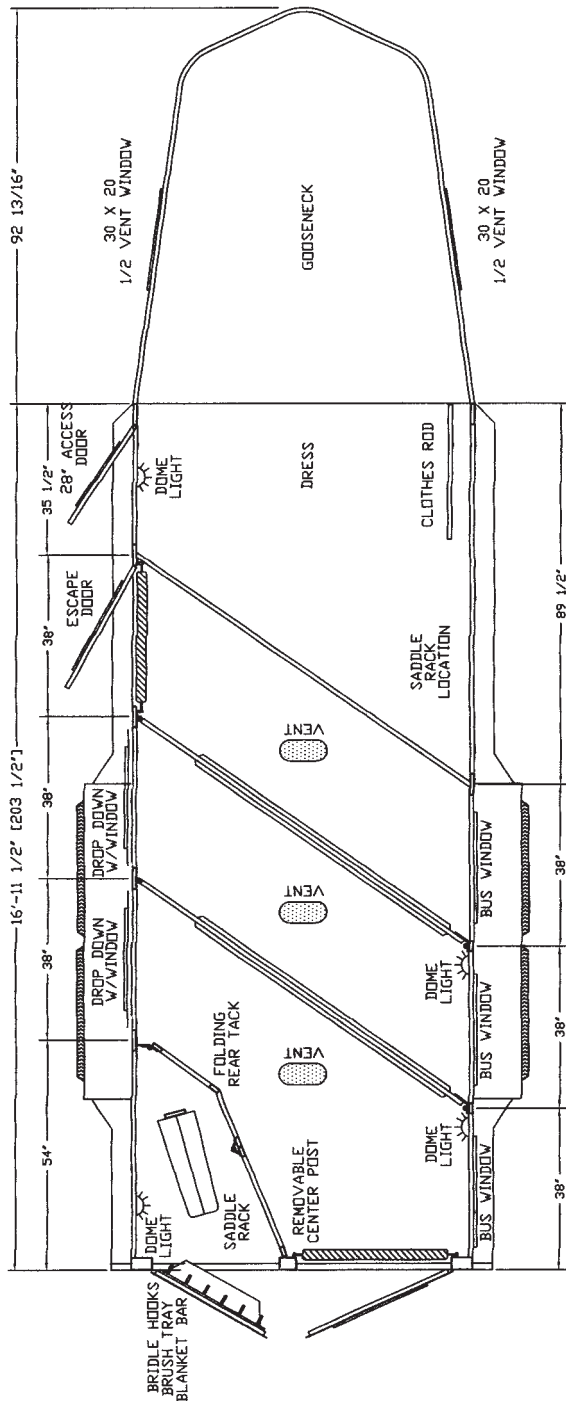

## Axles & Tires:

- \* 2-6000 # Torsion Axles
- \* 4-235/85R/16-E
- \* Spare Tire Bracket & Mount Only

## Dressing Room:

- \* 3' Shortwall
- \* Dressing Room Door Street Side
- \* 1 Dome Light
- \* Carpeted Floor, Front Drop & Gooseneck Bed Area
- \* 2 Windows In Gooseneck
- \* 1 Clothes Bar

## Stall Area:

- \* 2 Head & Shoulder Dividers
- \* Rubber Lined Slant Wall, Hip Wall, Rear Tack Wall & Rear Load Door
- \* 2 Stall Lights
- \* 2 Drop Down Feed Doors W/ Safety Bars
- \* Escape Door W/ Slider Window W/ Safety Bars & Chest Safety Bar
- \* 1 - 24" X 28" Window Per Stall On Hip Wall
- \* 1 - 18" X 24" Window In Load Door
- \* 2 Interior Ties Per Stall
- \* 2 Exterior Ties Per Stall
- \* Heavy Duty Rubber Floor Mats
- \* Butt Bar
- \* 1 Roof Vent Per Stall

## Collapsible Rear Tack:

- \* 3 Position Saddle Rack
- \* 6 Bridle Hooks
- \* 1 Brush Tray
- \* 1 Blanket Bar
- \* 1 Dome Light



See your local dealer for options available or visit  
[www.cherokeetrailers.net](http://www.cherokeetrailers.net)

**Warranty: 2 Year Hitch to Bumper • 8 Year Structure**

Make and/or Model subject to change without notice